

ESTECEM II

ESTECEM II is a dual-cure (light and/or self-cure), radiopaque, adhesive resin cement system with excellent handling, esthetic and adhesive properties to teeth and all prosthetic materials.



Indications

- ✦ Cementation of indirect restorations (each prosthetic material)
- ✦ Repair of fractured crowns
- ✦ Cementation of veneers
- ✦ Cementation of adhesion bridges
- ✦ Cementation of metal or resin cores, metal or glass-fiber posts

Properties

- ✦ Universally usable
- ✦ Reliable bond strength to tooth structure and prosthesis
- ✦ Excellent physical properties and high wear resistance
- ✦ Low water absorption and low solubility
- ✦ Thin film thickness
- ✦ Outstanding esthetics and color stability
- ✦ Good radiopacity
- ✦ Simple handling and easy removal of excess material

Clinical use



Mixing UNIVERSAL BOND A + B

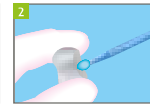

Apply mixed UNIVERSAL BOND to the surface of the restoration



Apply mild air to the surface

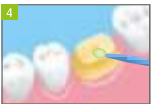

Apply the mixed UNIVERSAL BOND to the surface



Apply mild air continuously, then strong air to the surface

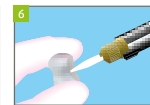

Apply the mixed ESTECEM II PASTE to the surface of the restoration, place the restoration on the tooth with firm pressure

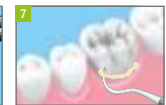

Removal of excess ESTECEM II PASTE



Final ESTECEM II PASTE hardening by light curing

Pack sizes available

Complete Kit (Universal only):

- Paste universal (9.4g)
- Universal Bond A (5ml)
- Universal Bond B (5ml)
- 15 x applicator tips
- 5 x applicator tips S
- 5 x nozzle for mini mixing tip S
- 25 x microbrushes
- 1 x mixing dish
- 5 x disposable mixing dish

Refill:

- Paste universal (9.4g)
- Paste brown (9.4g)
- Paste clear (9.4g)
- Paste white-opaque (9.4g)
- Universal Bond A (5ml)
- Universal Bond B (5ml)
- 40 x applicator tips
- 40 x applicator tips S
- 40 x nozzle for mini mixing tip S

Available in 4 different shades

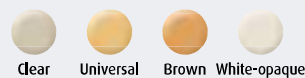

TOKUPOST

Your pre-prosthetic build up requires that your post-endodontic treatment has a solid foundation. TOKUPOST will be your esthetic and reliable basement.



Indications

- ✦ In case of insufficient residual tooth substance (more than one missing coronal wall)

Properties

- ✦ **NEW: Enhanced radiopacity**
- ✦ Quartz fibers for optimal light transmission
- ✦ High translucency
- ✦ Flexural modulus similar to dentine
- ✦ Calibrated drill
- ✦ Excellent radiopacity
- ✦ Color coding
- ✦ Good biocompatibility
- ✦ Verifier

Technical information

Type 15R

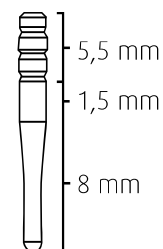

Type 18S

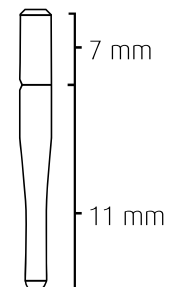

Pack sizes available

Trial Kit:

- 5 x posts 15R75 (ø 0.75 mm apical / 1.25 mm coronal)
- 5 x posts 18S75 (ø 0.75 mm apical / 1.45 mm coronal)
- 1 x calibrated drill (ø 0.75 mm)
- 1 x verifier (ø 0.75 mm)

Master Kit:

- 5 x posts 15R55 (ø 0.55 mm apical / 1.05 mm coronal)
- 5 x posts 15R75 (ø 0.75 mm apical / 1.25 mm coronal)
- 5 x posts 15R95 (ø 0.95 mm apical / 1.45 mm coronal)
- 5 x posts 18S55 (ø 0.55 mm apical / 1.25 mm coronal)
- 5 x posts 18S75 (ø 0.75 mm apical / 1.45 mm coronal)
- 5 x posts 18S95 (ø 0.95 mm apical / 1.65 mm coronal)
- 3 x calibrated drill (ø 0.55 / 0.75 / 0.95 mm)
- 3 x verifier (ø 0.55 / 0.75 / 0.95 mm)

Refill:

- 20 x posts 15R55 (ø 0.55 mm apical / 1.05 mm coronal)
- 20 x posts 15R75 (ø 0.75 mm apical coronal I / 1.25 mm coronal)
- 20 x posts 15R95 (ø 0.95 mm apical / 1.45 mm coronal)
- 20 x posts 18S55 (ø 0.55 mm apical / 1.25 mm coronal)
- 20 x posts 18S75 (ø 0.75 mm apical / 1.45 mm coronal)
- 20 x posts 18S95 (ø 0.95 mm apical / 1.65 mm coronal)
- 3 x calibrated drills (ø 0.55 / 0.75 / 0.95 mm)
- 3 x verifier (ø 0.55 / 0.75 / 0.95 mm)

SYMPRESS

SYMPRESS is the ideal supplement for ESTESIL H₂TOP when it comes to mixing the 5:1 cartridges as best as possible by machine.



NEW

Indications

- ✦ Mixing and extruding of dental 5:1 impression material cartridges or foil bags in cartridge holders

Properties

- ✦ Precise dispensing, mixing and applying for reproducible results
- ✦ Ideal mixed consistency
- ✦ Different mixing speeds
- ✦ Easy and hygienic at the touch of a button
- ✦ Automatic flow and return

Technical information

Convenient handling



Pack sizes available

Complete Kit:

- SYMPRESS mixing machine
- Power cable
- Instruction for use
- Spare parts list

ESTESIL H₂TOP™

Ultra flowable and wettable silicone material
for precise reading in the minutest detail

NEW



Indications

- ✦ Monophase or dual phase impressions for implants, crowns, bridges, inlays, onlays or veneers
- ✦ Suited for all kind of impression techniques (putty-wash, dual arch, etc.)

Properties

- ✦ Precise detail reproduction even in extreme conditions
- ✦ Very good recovery after deformation
- ✦ Excellent tear strength
- ✦ Outstanding initial flowability
- ✦ Perfect hydrophilicity thanks to additive surfactants



New viscosity
as supplement:
Regular Flow.

Pack sizes available

Refill:

- Putty soft (2 x 300ml + 2 measuring scoops)
- 5:1 cartridge Monophase (2 x 380ml + 10 mixing tips + 1 mixing ring)
- 5:1 cartridge Monoimplant (2 x 380ml + 10 mixing tips + 1 mixing ring)
- 1:1 cartridge Heavy Body (2 x 50ml + 6 mixing tips)
- 1:1 cartridge Regular Flow (2 x 50ml + 6 mixing tips + 6 intraoral tips)
- 1:1 cartridge High Flow (2 x 50ml + 6 mixing tips + 6 intraoral tips)
- 1:1 cartridge Extra High Flow (2 x 50ml + 6 mixing tips + 6 intraoral tips)
- 50 dynamic mixing tips
- 5 dynamic mixing rings
- 50 mixing tips Save (yellow)
- 50 mixing tips Save (teal)
- Dispensing gun (Standard)
- Dispensing gun (Easy)

ESTESIL H₂TOP™ FAST

Ultra flowable and wettable silicone material
for precise reading in the minutest detail



Indications

- ✦ Monophase or dual phase impressions for implants, crowns, bridges, inlays, onlays or veneers
- ✦ Suited for all kind of impression techniques (putty-wash, dual arch, etc.)

Properties

- ✦ **Fast type with rapid curing**
- ✦ Precise detail reproduction even in extreme conditions
- ✦ Very good recovery after deformation
- ✦ Excellent tear strength
- ✦ Outstanding initial flowability
- ✦ Perfect hydrophilicity thanks to additive surfactants

Technical information

Shark fin test

24 mm
Best Flow
Least Flow
12 mm

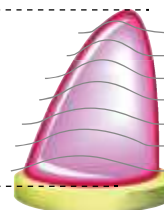

TOKUYAMA ESTESIL H₂TOP™

Examix
Imprint II
Splash
Take 1
Precision
Standout

Pack sizes available

Refill:

- Putty soft fast (2 x 300ml + 2 measuring scoops)
- 1:1 cartridge Regular Flow fast (2 x 50ml + 6 mixing tips + 6 intraoral tips)
- 1:1 cartridge High Flow fast (2 x 50ml + 6 mixing tips + 6 intraoral tips)
- 1:1 cartridge Extra High Flow fast (2 x 50ml + 6 mixing tips + 6 intraoral tips)